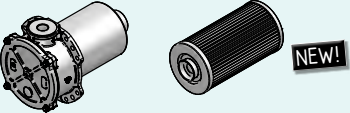
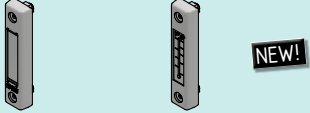

**FILTRIE ACCESSORI  
FILTER AND ACCESSORIES**

	Descrizione - Description	Type	Page
	FILTRO IN ASPIRAZIONE IN LINEA "SPIN-ON" <i>IN-LINE SUCTION "SPIN-ON" FILTER</i>	FACA AFAC AFCA	356
	FILTRO IN ASPIRAZIONE <i>THREADED SUCTION FILTER</i>	FIOA	357
	FILTRO SEMI-IMMERSO AL RITORNO <i>RETURN-LINE FILTER</i>	FIO FIOC CR	358
	INDICATORE DI LIVELLO VERTICALE <i>VERTICAL OIL LEVEL GAUGE</i>	LVO LVOT	359
	TAPPO DI CARICO OLIO CON SFIATO <i>FILTER CAP WITH BREATHER</i>	TCO	359

**FACA**

**AFAC - AFCA**

**NEW!**

FILTRO IN ASPIRAZIONE IN LINEA "SPIN-ON"  
IN-LINE SUCTION "SPIN-ON" FILTER

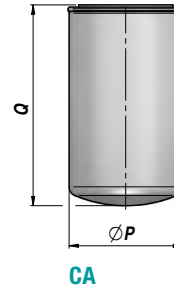
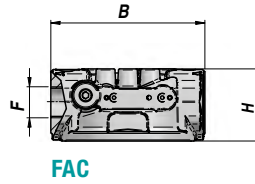
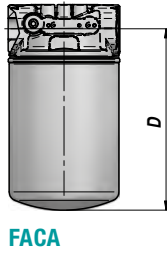

FACA					AFAC					AFCA						
FILTRO COMPLETO COMPLETE FILTER					TESTA FILTRO FILTER HEAD					CARTUCCIA ELEMENT						
Codice Code	Tipo Type	l/min max	D	kg	Codice Code	Tipo Type	F BSP	B	H	kg	Codice Code	Tipo Type	µm	ØP	Q	kg
AFACA06010	FACA 60/1-P	20	172	1,00	AFAC006001	FAC 60	3/4"	95	41.5	0,40	AFCA006010	CA 60/1	10	96	146	0,60
AFACA06030	FACA 60/3-P	25	"	1,00							AFCA006030	CA 60/3	30	"	"	0,60
AFACA06060	FACA 60/6-P	30	"	1,25							AFCA006060	CA 60/6	60	"	"	0,85
AFACA08010	FACA 80/1-P	25	232	1,10							AFCA008010	CA 80/1	10	96	209	0,70
AFACA08030	FACA 80/3-P	30	"	1,10							AFCA008030	CA 80/3	30	"	"	0,70
AFACA08060	FACA 80/6-P	35	"	1,35							AFCA008060	CA 80/6	60	"	"	0,95
AFACA16010	FACA 160/1-P	70	215	2,00	AFAC016001	FAC 160	1 1/4	132	61.5	0,85	AFCA016010	CA 160/1	10	128	181	1,15
AFACA16030	FACA 160/3-P	80	"	2,00							AFCA016030	CA 160/3	30	"	"	1,15
AFACA16060	FACA 160/6-P	80	"	2,15							AFCA016060	CA 160/6	60	"	"	1,30
AFACA20010	FACA 200/1-P	90	263	2,30							AFCA020010	CA 200/1	10	128	226	1,45
AFACA20030	FACA 200/3-P	100	"	2,30							AFCA020030	CA 200/3	30	"	"	1,45
AFACA20060	FACA 200/6-P	100	"	2,45							AFCA020060	CA 200/6	60	"	"	1,60

Testa filtro con predisposizione per indicatore - Filter head machined for indicator

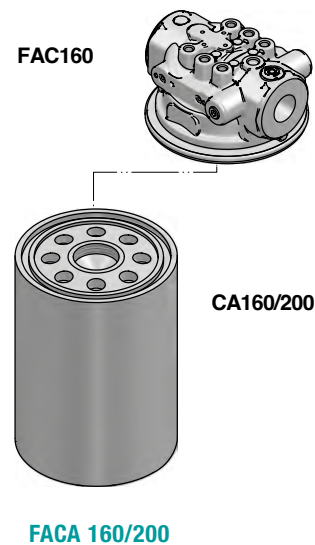
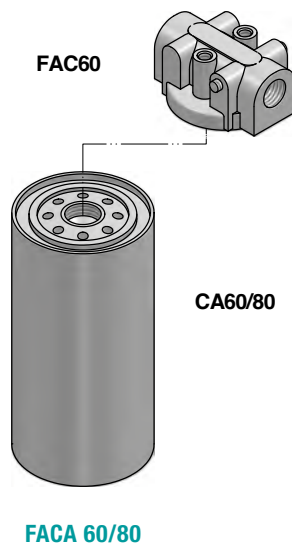

FILTRO INASPIRAZIONE  
 THREADED SUCTION FILTER

FIOA

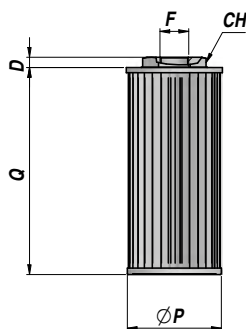

Codice Code	Tipo Type	l/min	F BSP	Micron	ØP	Q	D	CH	kg
AFIOA02060	FIOA 20/6	10	3/8"	60	52	68	9	22	0,10
AFIOA02000	FIOA 20/9	10	3/8"	90	52	68	9	22	0,10
AFIOA03560	FIOA 35/6	17	1/2"	60	69	76	12	27	0,16
AFIOA03500	FIOA 35/9	17	1/2"	90	69	76	12	27	0,16
AFIOA05060	FIOA 50/6	25	3/4"	60	75	83	12	36	0,20
AFIOA05000	FIOA 50/9	25	3/4"	90	75	83	12	36	0,20
AFIOA08560 <b>NEW!</b>	FIOA 85/6	43	1"	60	95	83	14	46	0,32
AFIOA08500 <b>NEW!</b>	FIOA 85/9	43	1"	90	95	83	14	46	0,32
AFIOA09060	FIOA 90/6	45	1"	60	75	131	10	46	0,50
AFIOA09000	FIOA 90/9	45	1"	90	75	131	10	46	0,50
AFIOA13060	FIOA 130/6	65	1"1/4	60	95	172	12	60	0,68
AFIOA13090	FIOA 130/9	65	1"1/4	90	95	172	12	60	0,68
AFIOA16060 <b>NEW!</b>	FIOA 160/6	80	1"1/2	60	86	130	12	60	0,60
AFIOA16000 <b>NEW!</b>	FIOA 160/9	80	1"1/2	90	86	130	12	60	0,60
AFIOA17560 <b>NEW!</b>	FIOA 175/6	85	1"1/2	60	140	98	15	60	0,70
AFIOA17500 <b>NEW!</b>	FIOA 175/9	85	1"1/2	90	140	98	15	60	0,70
AFIOA18060 <b>NEW!</b>	FIOA 180/6	90	1"1/2	60	95	205	12	60	0,75
AFIOA18000 <b>NEW!</b>	FIOA 180/9	90	1"1/2	90	95	205	12	60	0,75

FIO

FIOC - CR

NEW!

FILTRO SEMI-IMMERSO AL RITORNO  
RETURN-LINE FILTER

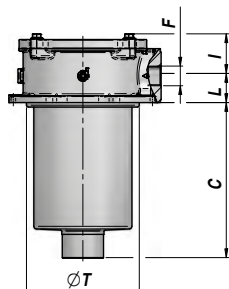
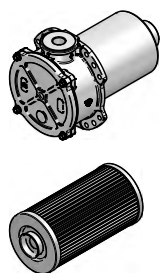

FIOC

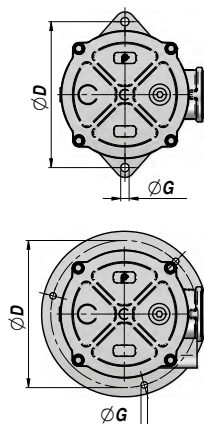

FIOC for FIO 30-100

FIOC for FIO 180

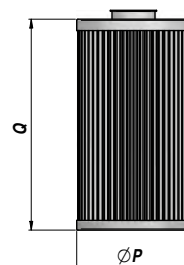

CR

FIO				FIOC										CR				
FILTRO COMPLETO COMPLETE FILTER				COMPONENTI FILTRO FILTER COMPONENTS										CARTUCCIA ELEMENT				
Codice Code	Tipo Type	l/min max	kg	Codice Code	F BSP	ØT	C	L	I	ØD	ØG	kg	Codice Code	Tipo Type	µm	ØP	Q	kg
AFIO030030	FIO 30/3-P	20	0,48	AFIOC03000	1/2"	67	78	22	32	90	6.4	0,35	AFCR030030	CR 30/3	30	52	67	0,13
AFIO030060	FIO 30/6-P	30	0,47										AFCR030060	CR 30/6	60	"	"	0,12
AFIO030000	FIO 30/9-P	30	0,51										AFCR030000	CR 30/9	90	"	"	0,16
AFIO050030	FIO 50/3-P	35	0,83	AFIOC05000	1/2"	90	100	28	44	115	8.4	0,62	AFCR050030	CR 50/3	30	70	75	0,21
AFIO050060	FIO 50/6-P	50	0,82										AFCR050060	CR 50/6	60	"	"	0,20
AFIO050000	FIO 50/9-P	50	0,86										AFCR050000	CR 50/9	90	"	"	0,24
AFIO060030	FIO 60/3-P	40	0,84	AFIOC06000	3/4"	90	100	28	44	115	8.4	0,62	AFCR060030	CR 60/3	30	70	82	0,22
AFIO060060	FIO 60/6-P	60	0,83										AFCR060060	CR 60/6	60	"	"	0,21
AFIO060000	FIO 60/9-P	60	0,85										AFCR060000	CR 60/9	90	"	"	0,23
AFIO080030	FIO 80/3-P	55	0,97	AFIOC08000	3/4"	90	150	28	44	115	8.4	0,62	AFCR100030	CR 100/3	30	70	128	0,30
AFIO080060	FIO 80/6-P	80	0,95										AFCR100060	CR 100/6	60	"	"	0,28
AFIO080000	FIO 80/9-P	80	1,00										AFCR100000	CR 100/9	90	"	"	0,33
AFIO100030	FIO 100/3-P	65	0,97	AFIOC10000	1"	90	150	28	44	115	10.5	0,62	AFCR100030	CR 100/3	30	70	128	0,30
AFIO100060	FIO 100/6-P	80	0,95										AFCR100060	CR 100/6	60	"	"	0,28
AFIO100000	FIO 100/9-P	80	1,00										AFCR100000	CR 100/9	90	"	"	0,33
AFIO150030	FIO 150/3-P	100	2,78	AFIOC15000	1"	130	224	35	56	175	10.5	2,00	AFCR150030	CR 150/3	30	95	203	0,55
AFIO150060	FIO 150/6-P	150	2,75										AFCR150060	CR 150/6	60	"	"	0,52
AFIO150000	FIO 150/9-P	150	3,10										AFCR150000	CR 150/9	90	"	"	0,87
AFIO180030	FIO 180/3-P	120	2,53	AFIOC18000	1 1/4"	130	224	35	56	175	10.5	2,00	AFCR180030	CR 180/3	30	95	203	0,55
AFIO180060	FIO 180/6-P	180	2,50										AFCR180060	CR 180/6	60	"	"	0,52
AFIO180000	FIO 180/9-P	180	2,85										AFCR180000	CR 180/9	90	"	"	0,87

Testa filtro con predisposizione per indicatore - Filter head machined for indicator

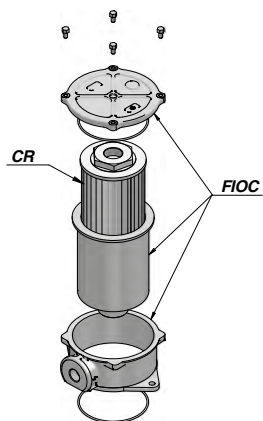

FIO 20/30

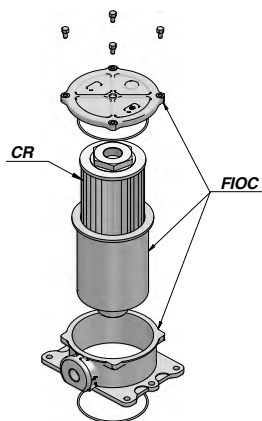

FIO 50/100

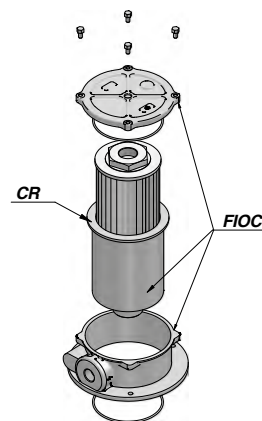

FIO 150/180

INDICATORE DI LIVELLO OLIO VERTICALE  
VERTICAL OIL LEVEL GAUGE

NEW!

LVO - LVOT

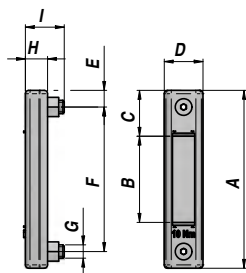

LVO

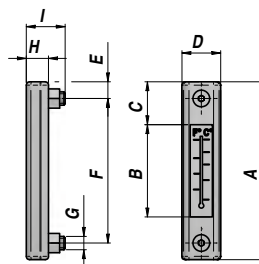

LVOT

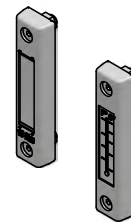

Codice Code	Tipo Type	A	B	C	D	E	F	G	H	I	kg
ALV0007610	LVO 76/10	108	31				76	M10			0,20
ALV0007612	LVO 76/12	108	31				76	M12			0,20
ALV0012710	LVO 127/10	159	82	39	37	16	127	M10	23	41	0,24
ALV0012712	LVO 127/12	159	82				127	M12			0,24
ALV0025412	LVO 254/12	285	209				254	M12			0,40
ALVOT07610	LVOT 76/10	108	31				76	M10			0,20
ALVOT07612	LVOT 76/12	108	31				76	M12			0,20
ALVOT12710	LVOT 127/10	159	82	39	37	16	127	M10	23	41	0,24
ALVOT12712	LVOT 127/12	159	82				127	M12			0,24
ALVOT25412	LVOT 254/12	285	209				254	M12			0,40

TAPPO DI CARICO OLIO CON SFIATO  
FILLER CAP WITH BREATHER

NEW!

TCO

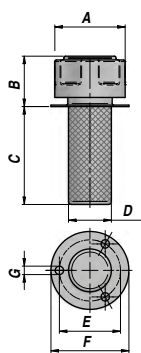

TCO300

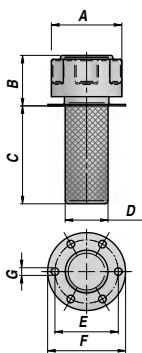

TCO500

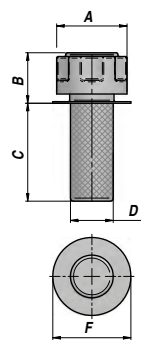

TCO501

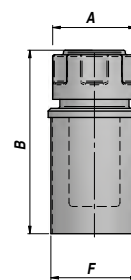

TCO502



Codice Code	Tipo Type	Sfiato - Breather		A	B	C	D	E	F	G	kg
		µm	l/min								
ATCO300000	TCO 300/4	40	300	46	35	63	28	41	51	5.5	0,10
ATCO301000	TCO 300/1	10	270	46	35	63	28	41	51	5.5	0,10
ATCO500000	TCO 500/4	40	500	70	46	100	40	73	84	5.5	0,25
ATCO501000	TCO 500/1	10	470	70	46	100	40	73	84	5.5	0,25
ATCO500100	TCO 501/4	40	500	70	46	100	40	-	84	-	0,25
ATCO501100	TCO 501/1	10	470	70	46	100	40	-	84	-	0,25
ATCO500200	TCO 502/4	40	500	70	180	-	-	-	64	-	0,60
ATCO501200	TCO 502/1	10	470	70	180	-	-	-	64	-	0,60