

ACCUMULATORI E STRUMENTI DI MISURAZIONE ACCUMULATORS AND MEASUREMENT INSTRUMENTS

	Descrizione - Description	Type	Page
	ACCUMULATORE IDROPNEUMATICO A MEMBRANA <i>DIAPHRAGM HYDROPNEUMATIC ACCUMULATOR</i>	H	346
 NEW!	ACCUMULATORE IDROPNEUMATICO A MEMBRANA <i>DIAPHRAGM HYDROPNEUMATIC ACCUMULATOR</i>	HST	346
	ACCUMULATORE IDROPNEUMATICO A SACCA <i>BLADDER HYDROPNEUMATIC ACCUMULATOR</i>	HTR	347
 NEW!	ACCUMULATORE IDROPNEUMATICO A SACCA <i>BLADDER HYDROPNEUMATIC ACCUMULATOR</i>	HB	347
 NEW!	COLLARI PER FISSAGGIO ACCUMULATORI <i>MOUNTING CLAMPS FOR ACCUMULATORS</i>	ACR ACRE	348
 NEW!	VALIGETTA CON APPARECCHIATURA PER RICARICA E CONTROLLO ACCUMULATORI <i>CASE FOR FILLING AND CONTROL DEVICE FOR ACCUMULATORS</i>	ACAR	348
	PRESSOSTATO REGOLABILE <i>ADJUSTABLE PRESSURE SWITCH</i>	F5 F4	349
 NEW!	PRESSOSTATO REGOLABILE <i>ADJUSTABLE PRESSURE SWITCH</i>	K5	350
 NEW!	PRESSOSTATO ELETTRONICO VISUALIZZATO <i>ELECTRONIC PRESSURE SWITCH DISPLAY</i>	KLV5	350
 NEW!	TERMOSTATO BIMETALLICO <i>BIMETALLIC THERMOSTAT</i>	TM4	351
	MANOMETRO CON GLICERINA - ATTACCO RADIALE <i>GLYCERINE PRESSURE GAUGE - RADIAL FITTING</i>	AMGR	351
 NEW!	MINIPRESA FILETTATA <i>THREADED COUPLING</i>	AM-E AM-C AM-D	352
	PORTA MANOMETRO E CONNETTORE PORTA MANOMETRO <i>GAUGE ADAPTER AND SWIVEL PRESSURE GAUGE CONNECTION</i>	AM20 AM18 AM18.M	353
 NEW!	ESCLUSORE PER MANOMETRO <i>GAUGE ISOLATOR</i>	EMIL EM90	354

H

ACCUMULATORE IDROPNEUMATICO A MEMBRANA
DIAPHRAGM HYDROPNEUMATIC ACCUMULATOR

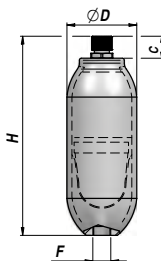
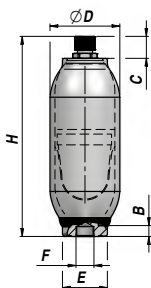
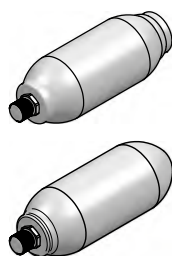

H990R - H3000R

Conforme a - Compliant with :
97/23/CE-PED
94/9/CE-ATEX GII Cat2
GOST-R (Russia)
SELO (China)

Codice Code	Tipo Type	P MAX	Azoto Nitrogen	H	ØD	E	B	C	F	Q MAX l/min	kg
ACH0000100	H 150 R	250	lt 0.15	142	70	45	15	23	M18x1.5	40	1,20
ACH0000350	H 350 R	250	lt 0.35	190	70	35	15	23	M18x1.5	35	1,70
ACH0000500	H 500 R	250	lt 0.45	167	92	55	17	23	M18x1.5	50	1,90
ACH0000700	H 700 R	250	lt 0.70	220	92	40	17	23	M18x1.5	40	2,70
ACH0000990 NEW!	H 990 R	250	lt 0.99	251	92	-	-	23	M18x1.5	50	4,00
ACH0001000	H 1000 R	250	lt 1.00	200	115	60	19	23	M18x1.5	50	3,50
ACH0001400	H 1400 R	250	lt 1.40	270	115	60	19	23	M18x1.5	40	4,90
ACH0002000	H 2000 R	250	lt 2.00	350	115	60	19	23	M18x1.5	40	5,80
ACH0003000 NEW!	H 3000 R	250	lt 2.80	400	115	-	-	23	1/2" BSP	60	7,50
ACH0004000	H 4000 R	210	lt 3.80	320	170	95	15	23	3/4" BSP	80	14,00

Temperatura d'esercizio - Working temperature : -20°C - +80°C

MATERIALE CORPO : ACCIAIO
BODY MATERIAL : STEEL

MATERIALE MEMBRANA : NBR
DIAPHRAGM MATERIAL : NBR

HST

NEW!

ACCUMULATORE IDROPNEUMATICO A MEMBRANA
DIAPHRAGM HYDROPNEUMATIC ACCUMULATOR

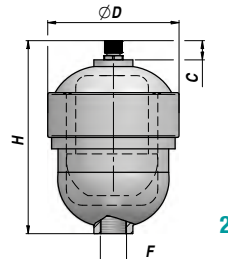
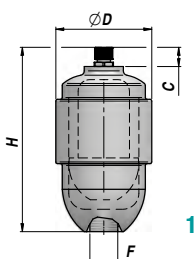
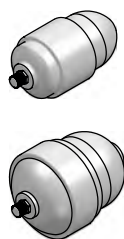

Conforme a - Compliant with :
97/23/CE-PED
94/9/CE-ATEX GII Cat2
GOST-R (Russia)
SELO (China)

Codice Code	Tipo Type	P MAX bar	Azoto Nitrogen	H	ØD	C	F	Q MAX l/min	Disegno Drawing	kg
ACHST00040	HST 0.05	300	lt 0.05	98	60	22	M18x1.5	35	1	1,10
ACHST00100	HST 0.15	300	lt 0.15	141	80	22	M18x1.5	45	1	2,10
ACHST00350	HST 0.35	300	lt 0.35	152	101	22	M18x1.5	50	1	3,20
ACHST00500	HST 0.5	300	lt 0.50	175	124	22	M18x1.5	60	1	5,00
ACHST00700	HST 0.7	300	lt 0.70	218	100	22	M18x1.5	55	1	5,50
ACHST00800	HST 0.8	300	lt 0.80	185	138	22	M18x1.5	60	2	5,80
ACHST01300	HST 1.3	300	lt 1.30	232	125	22	M18x1.5	55	1	7,90
ACHST01500	HST 1.5	300	lt 1.50	270	138	22	M18x1.5	55	2	8,70
ACHST02300	HST 2.3	300	lt 2.30	340	138	22	M18x1.5	55	2	10,50

Temperatura d'esercizio - Working temperature : -20°C - +80°C

MATERIALE CORPO : ACCIAIO
BODY MATERIAL : STEEL

MATERIALE MEMBRANA : NBR
DIAPHRAGM MATERIAL : NBR

ACCUMULATORE IDROPNEUMATICO A SACCA
BLADDER HYDROPNEUMATIC ACCUMULATOR

HTR

Conforme a - *Compliant with* :
97/23/CE-PED
94/9/CE-ATEX GII Cat2
ASME VIII Div.1
GOST-R (Russia)
SELO (China)

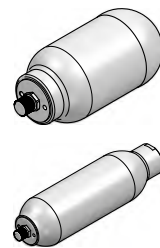
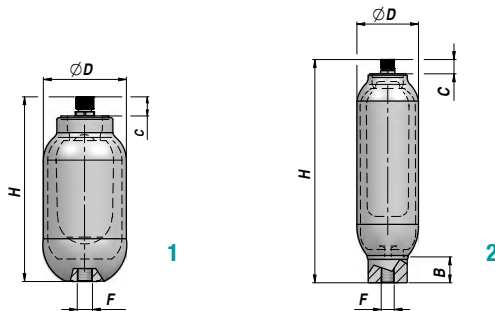

Codice Code	Tipo Type	P MAX bar	Azoto Nitrogen	H	ØD	B	C	F	Q MAX l/min	Disegno Drawing	kg
ACHTR01500	HTR 1.5	250	lit 1.50	280	115	25	15	M18x1.5	40	1	5,30
ACHTR02500	HTR 2.5	250	lit 2.50	483	115	50	15	1"1/4 BSP	110	2	11,50
ACHTR04501	HTR 4.5	210	lit 4.50	395	170	80	15	1"1/4 BSP	400	2	15,00
ACHTR06500	HTR 6.5	210	lit 6.50	520	170	60	20	1"1/4 BSP	350	2	24,00
ACHTR10000	HTR 10	210	lit 10.00	760	170	80	15	1"1/4 BSP	300	2	31,00

Temperatura d'esercizio - *Working temperature* : -20°C - +80°C

MATERIALE CORPO : ACCIAIO MATERIALE SACCA : NBR
BODY MATERIAL : STEEL BLADDER MATERIAL : NBR

ACCUMULATORE IDROPNEUMATICO A SACCA
BLADDER HYDROPNEUMATIC ACCUMULATOR

NEW!

HB

Conforme a - *Compliant with* :
97/23/CE-PED
94/9/CE-ATEX GII Cat2
ASME-USTAMP
GOST-R (Russia)
SELO (China)

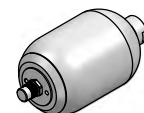
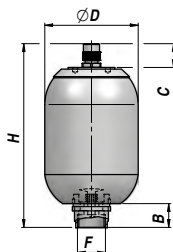

Codice Code	Tipo Type	P MAX bar	Azoto Nitrogen	H	ØD	B	C	F BSP	Q MAX l/min	kg
ACHB025330	HB 2.5	350	lit 2.50	495	114	60	25	1"1/4	220	12,00
ACHB045330	HB 4.5	350	lit 4.00	410	168	60	47	1"1/4	400	16,00
ACHB060330	HB 6	350	lit 6.00	505	168	60	47	1"1/4	350	19,50
ACHB100330	HB 10	350	lit 10.00	775	168	60	47	1"1/4	300	36,00
ACHB102330	HB 10/2	330	lit 10.00	550	223	60	45	2"	630	48,00
ACHB200330	HB 20	330	lit 18.50	870	223	60	60	2"	600	53,00
ACHB250330	HB 25	330	lit 24.90	1030	223	60	60	2"	570	62,00
ACHB350330	HB 35	330	lit 33.50	1400	223	60	60	2"	540	84,00
ACHB500330	HB 50	330	lit 49.00	1900	223	60	60	2"	500	115,00

Temperatura d'esercizio - *Working temperature* : -20°C - +80°C

MATERIALE CORPO : ACCIAIO MATERIALE SACCA : NBR
BODY MATERIAL : STEEL BLADDER MATERIAL : NBR

ACR-ACRE **NEW!**

**COLLARI PER FISSAGGIO ACCUMULATORI
MOUNTING CLAMPS FOR ACCUMULATORS**

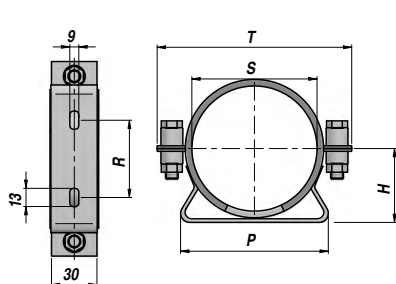
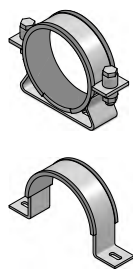

ACR

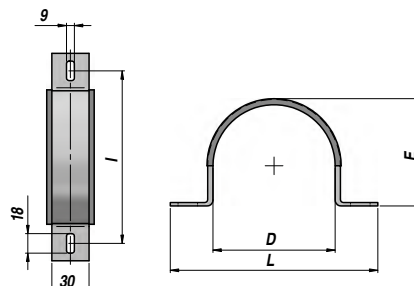

ACRE

Codice Code	Tipo Type	S	R	T	H	P	L	I	D	E	kg
ACR1140000	CR 114	114 ÷ 116	100	180	66	137	-	-	-	-	0,84
ACR1680000	CR 168	168 ÷ 172	148	230	93	180	-	-	-	-	1,00
ACR2230000	CR 223	216 ÷ 225	216	290	110	253	-	-	-	-	1,22
ACRE070000	CRE 70	-	-	-	-	-	125	99	70	68	0,12
ACRE092000	CRE 92	-	-	-	-	-	150	125	92	90	0,15
ACRE115000	CRE 115	-	-	-	-	-	185	160	115	113	0,20
ACRE125000	CRE 125	-	-	-	-	-	190	165	125	123	0,25
ACRE138000	CRE 138	-	-	-	-	-	215	190	138	136	0,30

MATERIALE : ACCIAIO
MATERIAL : STEEL

ACAR **NEW!**

**VALIGETTA CON APPARECCHIATURA PER RICARICA E CONTROLLO ACCUMULATORI
CASE FOR FILLING AND CONTROL DEVICE FOR ACCUMULATORS**

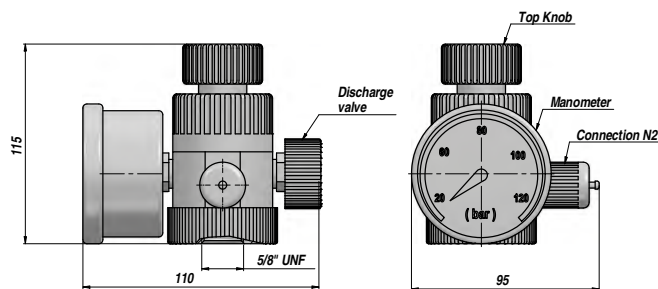
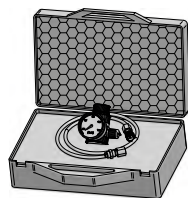

Codice Code	Tipo Type	Scala del manometro Pressure gauge range	Manometro Pressure gauge	Tubo flessibile Flexible hose	kg
ACAR100000	AR1- 40	0 > 40 bar	Ø63	5/64" DN2 L=2500 mm	1,00
ACAR200000	AR2- 60	0 > 60 bar			1,00
ACAR300000	AR3-100	0 > 100 bar			1,00
ACAR400000	AR4-160	0 > 160 bar			1,00
ACAR500000	AR5-250	0 > 250 bar			1,00
ACAR600000	AR6-400	0 > 400 bar			1,00

MATERIALE CORPO : ACCIAIO
BODY MATERIAL : STEEL

**PRESSOSTATO REGOLABILE
ADJUSTABLE PRESSURE SWITCH**

F5

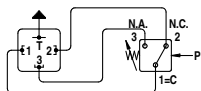
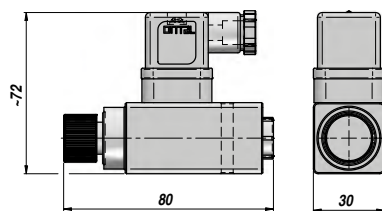
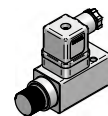

Codice Code	Tipo Type	Campo di Regolazione Setting Range	Esecuzione Execution	P MAX bar	Filetto Thread BSP	kg
APIF530000	F53	5 > 50 bar		300		0,15
APIF550000	F55	15 > 150 bar	Piston	350	1/4"	0,15
APIF570000	F57	30 > 300 bar		400		0,15

Temperatura d'esercizio - Working temperature : -20°C - +80°C

MATERIALE CORPO : ALLUMINIO
BODY MATERIAL : ALUMINIUM

**PRESSOSTATO REGOLABILE CON CAPPUCCIO DI PROTEZIONE (P1)
ADJUSTABLE PRESSURE SWITCH WITH PROTECTION CAP (P1)**

F4

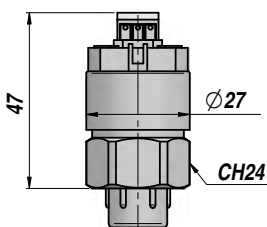
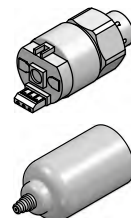

P1

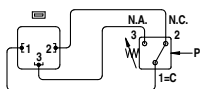

Codice Code	Tipo Type	Campo di Regolazione Setting Range	Esecuzione Execution	P MAX bar	Filetto Thread BSP	kg
APIF4R10P2	F4R-1-P2+P1	0.2 > 2.5 bar	Membrane	25		0,05
APIF4S10P2	F4S-1-P2+P1	1 > 12 bar	Membrane	25		0,05
APIF4T10P2	F4T-1-P2+P1	5 > 50 bar	Piston	300	1/4"	0,05
APIF4V10P2	F4V-1-P2+P1	10 > 100 bar	Piston	300		0,05
APIF4Z10P2	F4Z-1-P2+P1	20 > 200 bar	Piston	300		0,05
APIF4Y10P2 NEW!	F4Y-1-P2+P1	50 > 400 bar	Piston	600		0,05

Temperatura d'esercizio - Working temperature : -20°C - +80°C

MATERIALE CORPO : ACCIAIO
BODY MATERIAL : STEEL

K5

NEW!

PRESSOSTATO REGOLABILE
ADJUSTABLE PRESSURE SWITCH

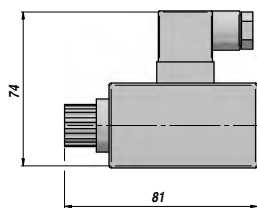
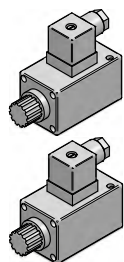

K

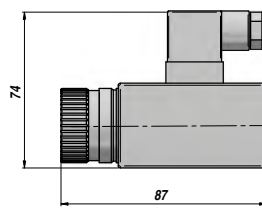
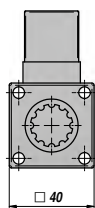

KP

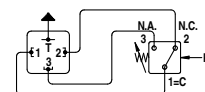
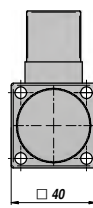

Codice Code	Tipo Type	Campo di Regolazione Setting Range	Esecuzione Execution	P MAX bar	Connessione Connection	kg	
APIK530000	K53	2 > 40 bar	Pistons	200	1/4" BSP femmina o collegamento diretto a pannello Cetop	0,35	
APIK540000	K54	5 > 100 bar		300		0,35	
APIK550000	K55	20 > 200 bar		400		0,35	
APIK570000	K57	30 > 300 bar		500		0,35	
APIK590000	K59	40 > 400 bar		600		0,35	
APIK53P000	K53-P	2 > 40 bar		200		1/4" BSP female or direct connection to a Cetop panel	0,40
APIK54P000	K54-P	5 > 100 bar		300		0,40	
APIK55P000	K55-P	20 > 200 bar		400		0,40	
APIK57P000	K57-P	30 > 300 bar		500		0,40	
APIK59P000	K59-P	40 > 400 bar		600		0,40	

Temperatura d'esercizio - Working temperature : -20°C - +80°C

MATERIALE CORPO : ALLUMINIO
BODY MATERIAL : ALUMINIUM

KLV5

NEW!

PRESSOSTATO ELETTRONICO VISUALIZZATO
ELECTRONIC PRESSURE SWITCH DISPLAY

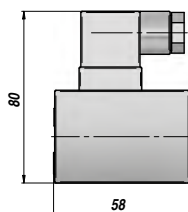
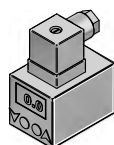

+12/24 VDC = Pin 1
GND = Pin 2
NC = Pin 3
NA = Pin 4

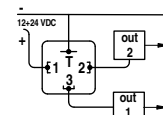

Codice Code	Tipo Type	Campo di Regolazione Setting Range	Esecuzione Execution	P MAX bar	Filetto Thread BSP	kg
APIKLV5010	KLV50.1-B-M3	0 > 2 bar	B-M3 **	7.5	1/4"	0,43
APIKLV5000	KLV50-B-M3	0 > 5 bar		12.0		0,43
APIKLV5100	KLV51-B-M3	0 > 10 bar		25.0		0,43
APIKLV5200	KLV52-B-M3	0 > 20 bar		50.0		0,43
APIKLV5300	KLV53-B-M3	0 > 50 bar		120.0		0,43
APIKLV5400	KLV54-B-M3	0 > 100 bar		250.0		0,43
APIKLV5500	KLV55-B-M3	0 > 200 bar		500.0		0,43
APIKLV5900	KLV59-B-M3	0 > 400 bar		600.0		0,43
APIKLV5960	KLV59.6-B-M3	0 > 600 bar		800.0		0,43

** B-M3 = Contatti separati : Aperto + Chiuso (NA + NC) - Con connettore
** B-M3 = Separate contacts : Open + Closed (NO + NC) - With connector

Temperatura d'esercizio - Working temperature : -20°C - +80°C

MATERIALE CORPO : ALLUMINIO
BODY MATERIAL : ALUMINIUM

TERMOSTATO BIMETALLICO
BIMETALLIC THERMOSTAT

NEW!

TM4

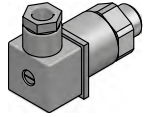
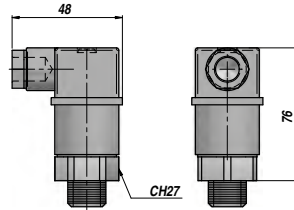

Codice Code	Tipo Type	Valore fisso d'intervento Fix set switching °C	Contatto elettrico Electric contact	P MAX bar	Filetto Thread BSP	kg
ATTM44A100	TM44 -A1	40	NA = Normalmente Aperto Normally Open	200	1/2"	0,07
ATTM45A100	TM45 -A1	50				0,07
ATTM46A100	TM46 -A1	60				0,07
ATTM47A100	TM47 -A1	70				0,07
ATTM48A100	TM48 -A1	80				0,07
ATTM49A100	TM49 -A1	90				0,07
ATTM490A10	TM49.0-A1	100				0,07
ATTM491A10	TM49.1-A1	110				0,07
ATTM492A10	TM49.2-A1	120				0,07

Temperatura d'esercizio - Working temperature : -20°C - +80°C

MATERIALE CORPO : OTTONE
BODY MATERIAL : BRASS

MANOMETRO CON GLIGERINA - ATTACCO RADIALE
GLYCERINE PRESSURE GAUGE - RADIAL FITTING

AMGR

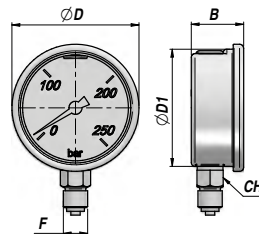

Codice Code	DN	F BSP	Scala Range bar	B	CH	ØD	kg
AMGR063010	63	1/4"	0 / 10	28.0	14	68.0	0,20
AMGR063025	63		0 / 25				0,20
AMGR063060	63		0 / 60				0,20
AMGR063100	63		0 / 100				0,20
AMGR063160	63		0 / 160				0,20
AMGR063250	63		0 / 250				0,20
AMGR063400	63		0 / 400				0,20
AMGR063600	63		0 / 600				0,20
AMGR100010	100	1/2"	0 / 10	33.9	17	109.8	0,40
AMGR100025	100		0 / 25				0,40
AMGR100060	100		0 / 60				0,40
AMGR100100	100		0 / 100				0,40
AMGR100160	100		0 / 160				0,40
AMGR100250	100		0 / 250				0,40
AMGR100400	100		0 / 400				0,40
AMGR100600	100		0 / 600				0,40

MATERIALE CORPO : CASSA IN ACCIAIO INOSSIDABILE
BODY MATERIAL : STAINLESS STEEL CASING

AM-E

NEW!

MINIPRESA FILETTATA M16x2 - TIPO "E"
THREADED COUPLING M16x2 - TYPE "E"

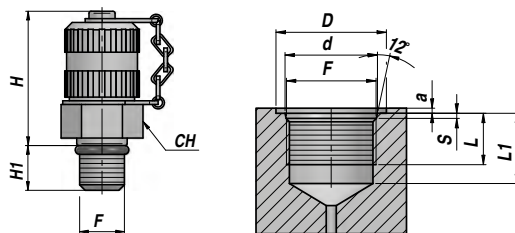
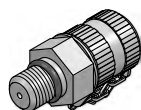

TYPE E

Codice Code	F	PN bar	H	H1	CH	d	D	L	L1	S	a	kg x100
AM0171X20C *	7/16"-20UNF	630	37	9	17	12.4	17	11.5	14.0	2.4	1.6	6,50
AM0112X20C	1/2"-20UNF	630	37	10	17	14.0	18	11.5	14.0	2.4	1.6	6,80
AM0191X18C *	9/16"-18UNF	630	37	10	19	15.6	20	12.7	15.5	2.5	1.6	7,60
AM0134X16C	3/4"-16UNF	630	37	14	22	20.5	25	16.0	20.0	2.6	2.4	8,00

PN = Pressione Nominale - Nominal pressure

* = A RICHIESTA : ACCIAIO INOX AISI316 - ON REQUEST : STAINLESS STEEL AISI 316

MATERIALE : ACCIAIO

MATERIAL : STEEL

AM-C / AM-D

NEW!

MINIPRESA FILETTATA M16x2 - TIPO "C" E TIPO "D"
THREADED COUPLING M16x2 - TYPE "C" AND TYPE "D"

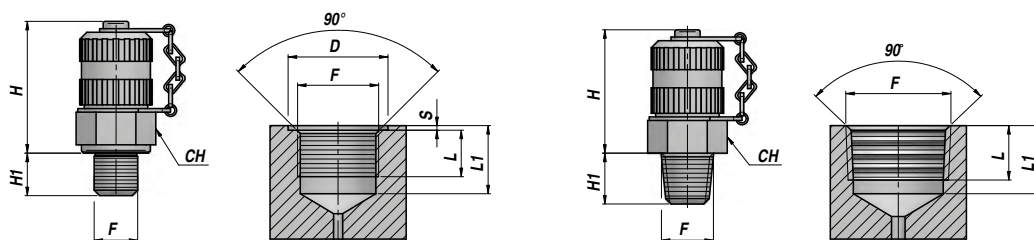
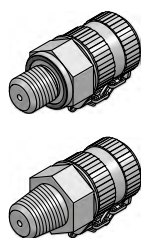

TYPE C

TYPE D

Codice Code	Tipo Type	F	PN	H	H1	CH	D	L	L1	S	kg x100
AM0718G00C *	C	1/8"	630	37	8	17	17	10.0	13.5	1.0	6,80
AM0714G00C *	C	1/4"	630	37	12	19	20	14.0	18.5	1.0	7,50
AM0738G00C *	C	3/8"	630	37	14	22	24	16.0	18.5	1.5	9,40
AM0712G00C *	C	1/2"	630	37	15	27	30	18.0	24.0	1.5	12,60
AM0410X10C *	C	M10x1	630	37	8	17	17	10.0	13.5	1.0	6,80
AM0612X15C *	C	M12x1.5	630	37	10	17	18	12.0	18.5	1.0	6,90
AM0614X15C *	C	M14x1.5	630	37	12	19	20	14.0	18.5	1.0	7,60
AM0616X15C	C	M16x1.5	630	37	12	22	22	14.0	18.5	1.5	8,50
AM0818280C *	D	1/8"	400	37	10	17	-	5.5	12.0	-	6,30
AM0814190C *	D	1/4"	630	37	12	19	-	8.5	13.5	-	7,40
AM0838190C	D	3/8"	630	37	14	22	-	12.0	20.0	-	8,00

PN = Pressione Nominale - Nominal pressure

* = A RICHIESTA : ACCIAIO INOX AISI316 - ON REQUEST : STAINLESS STEEL AISI 316

MATERIALE : ACCIAIO

MATERIAL : STEEL

PORTA MANOMETRO
GAUGE ADAPTER

NEW!

AM20

PORTA MANOMETRO
GAUGE ADAPTER

NEW!

AM18

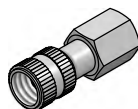
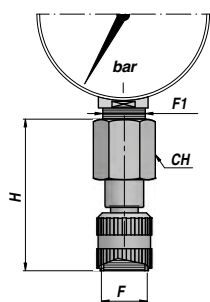

PASSAPARETE
BULKHEAD ADAPTER

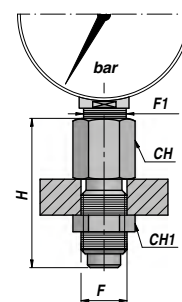

Codice Code	F	F1	PN	H	CH	kg x100
AM20140000 *	M16x2	1/4"	630	50	19	7,20
AM20120000 *	M16x2	1/2"	630	55	27	11,60

Codice Code	F	F1	PN	H	CH/CH1	kg x100
AM18140000 *	M16x2	1/4"	630	50	19/19	6,20
AM18120000 *	M16x2	1/2"	630	57	27/19	11,10

PN = Pressione Nominale - Nominal pressure

* = A RICHIESTA : ACCIAIO INOX AISI316 - ON REQUEST : STAINLESS STEEL AISI 316

MATERIALE : ACCIAIO
MATERIAL : STEEL

CONNETTORE PORTA MANOMETRO ORIENTABILE
SWIVEL PRESSURE GAUGE CONNECTION

NEW!

AM18.M

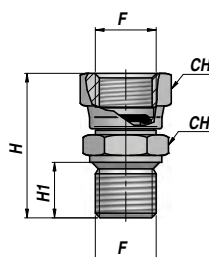

Codice Code	F	PN	H	H1	CH	kg x100
AM1814M000 *	1/4"	400	34	11	17	3,50
AM1812M000 *	1/2"	400	46	15	27	14,13

PN = Pressione Nominale - Nominal pressure

* = A RICHIESTA : ACCIAIO INOX AISI316 - ON REQUEST : STAINLESS STEEL AISI 316

A RICHIESTA : RONDELLA IN RAME - ON REQUEST : COPPER WASHER

MATERIALE : ACCIAIO
MATERIAL : STEEL

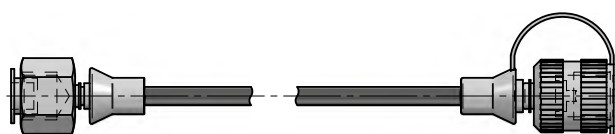

A RICHIESTA : TUBI CAPILLARI PER ALTA PRESSIONE CON RACCORDI
ON REQUEST : MICRO HOSE FOR HYGH PRESSURE WITH FITTINGS

EMIL

NEW!

ECLUSORE PER MANOMETRO - IN LINEA
GAUGE ISOLATOR - LINE TYPE

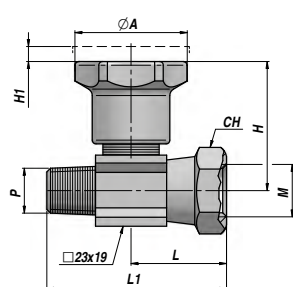

A

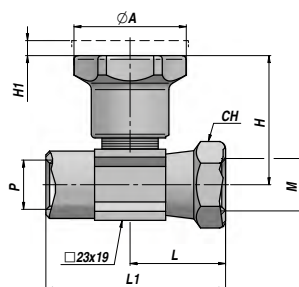

B

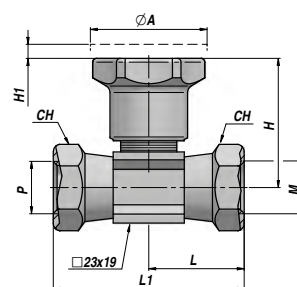

C

Codice Code	P	M BSP	Q MAX l/min	P MAX bar	Tipo Type	L1	L	H	H1	ØA	CH	kg
DFPE1G0400	1/4" BSPT	1/4"	5	350	EMIL 01-A	50	27	38	4	30	19	0,13
DFPE1G0401	1/4" BSP	1/4"	5	350	EMIL 01-B	48	27	38	4	30	19	0,14
DFPE1G0402	1/4" BSP	1/4"	5	350	EMIL 01-C	50	27	38	4	30	19	0,15

A RICHIESTA : DADO PASSAPARETE - ON REQUEST : PANEL MOUNTING NUT

MATERIALE CORPO : ACCIAIO
BODY MATERIAL : STEEL

MONTAGGIO IN LINEA
LINE MOUNTING

EM90

NEW!

ECLUSORE PER MANOMETRO - 90°
GAUGE ISOLATOR - 90° TYPE

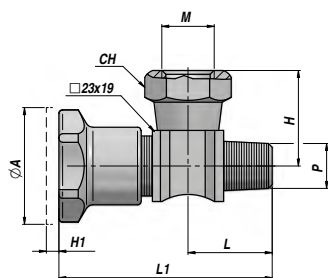
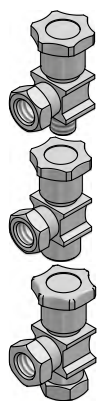

A

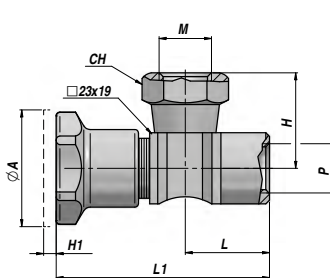

B

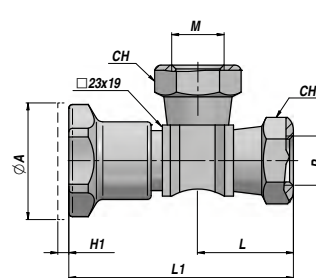

C

Codice Code	P	M BSP	Q MAX l/min	P MAX bar	Tipo Type	L1	L	H	H1	ØA	CH	kg
DFPEA1G040	1/4" BSPT	1/4"	5	350	EM90 01-A	60	24	38	4	30	19	0,13
DFPEA1G041	1/4" BSP	1/4"	5	350	EM90 01-B	58	22	38	4	30	19	0,13
DFPEA1G042	1/4" BSP	1/4"	5	350	EM90 01-C	62	26	38	4	30	19	0,14

A RICHIESTA : DADO PASSAPARETE - ON REQUEST : PANEL MOUNTING NUT

MATERIALE CORPO : ACCIAIO
BODY MATERIAL : STEEL

MONTAGGIO IN LINEA
LINE MOUNTING